



76 Wave Advantage Dispenser Image Refresh Installation Guide

This Phillips image refresh is for an Advantage pump dispenser. Please verify the specifications of your site before beginning. Contact LSI Customer Service at 1-800-231-0129 for installation support.

Read through all of the instructions prior to beginning installation, and verify (using the packing list) that all parts have been received and are in good condition.

Customer Service

Phone No. : 1-800-231-0129

Address: 14902 Sommermeyer Street, Ste. 120
Houston, TX 77041

Parts (Crest/Wave)

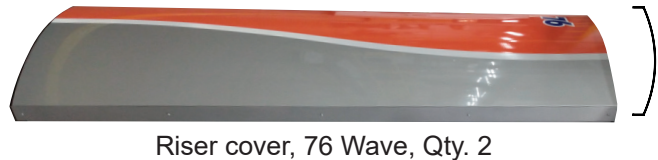
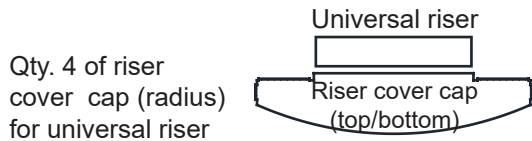

Door, 76 Wave,
Qty. 2

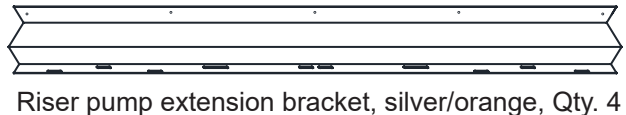

#8 X 3/4" K-lathe Tek screws
Qty. 20 silver and 20 orange



10-32 X 3/4" pan head machine
screws SS Qty. 10

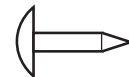

Remove/Install Doors, 2 Plcs

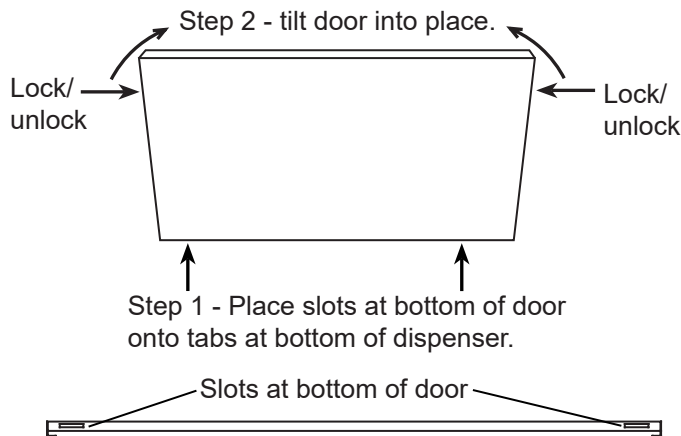

Install Extension Brackets

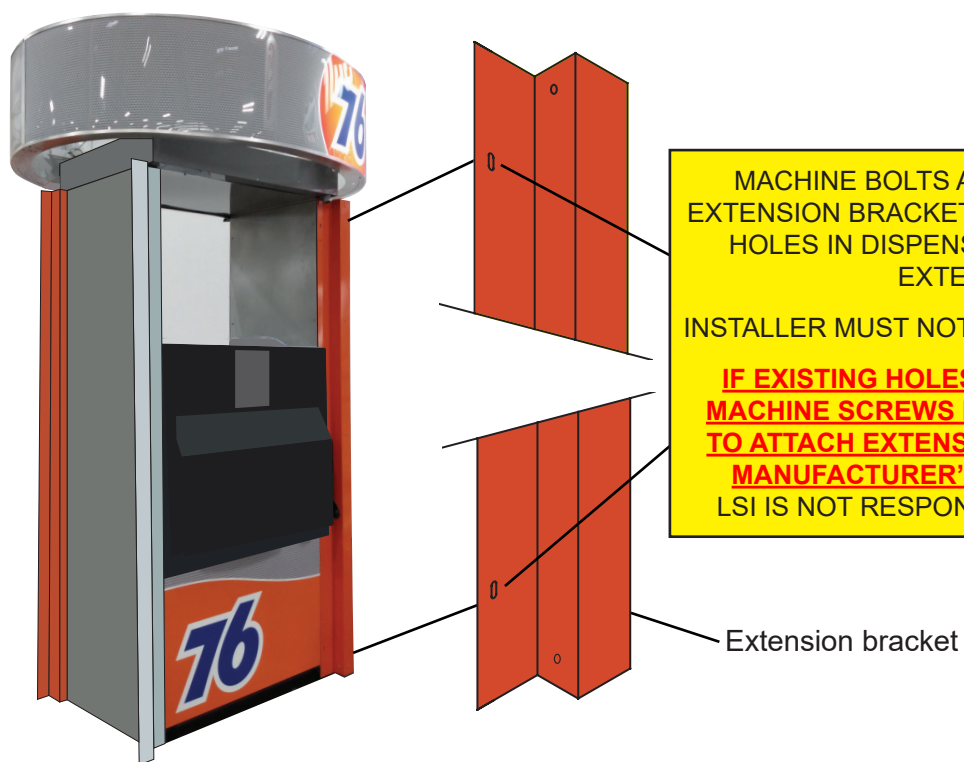

Install Top and Bottom Riser Cover Caps

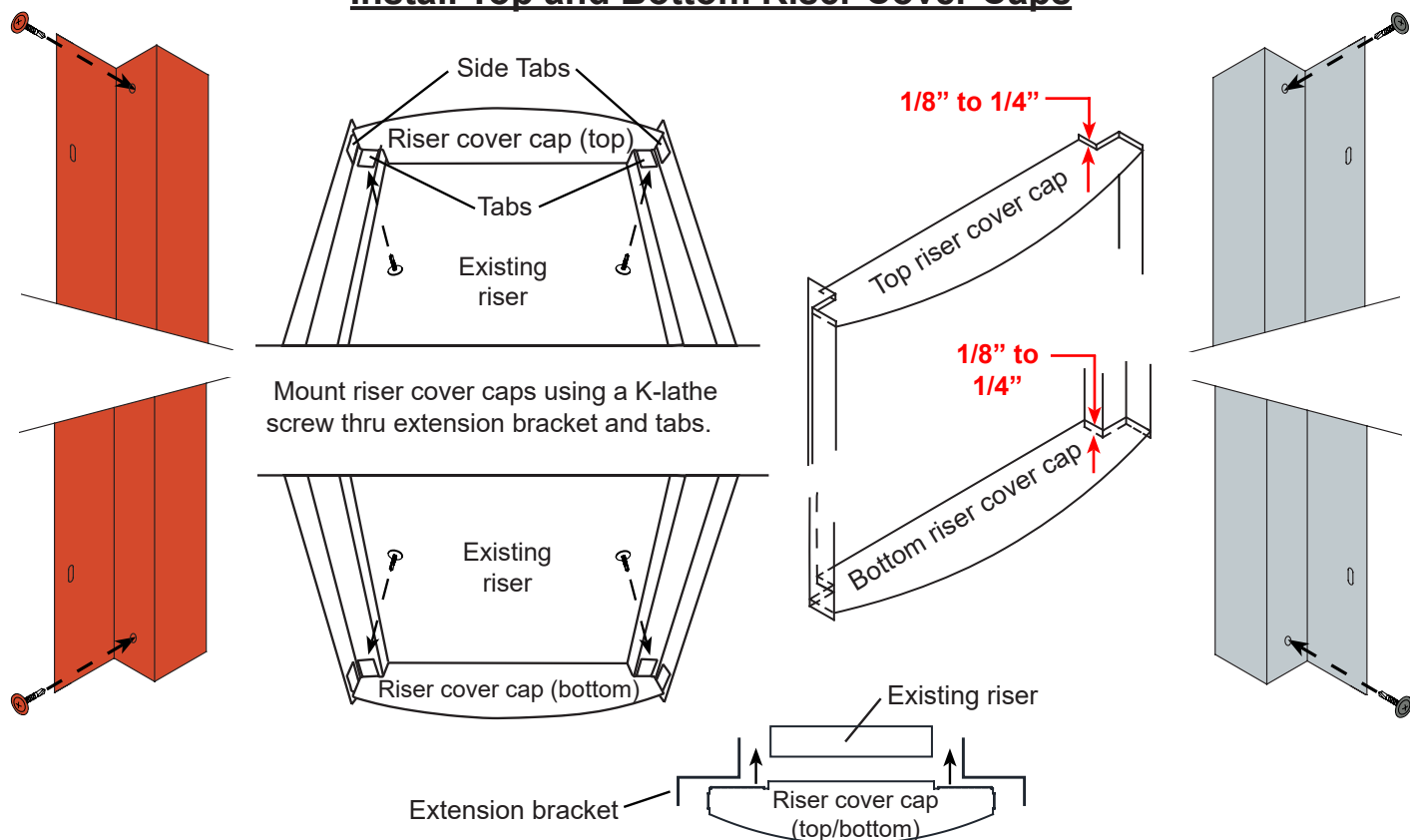

Install Riser Covers (2 Plcs)

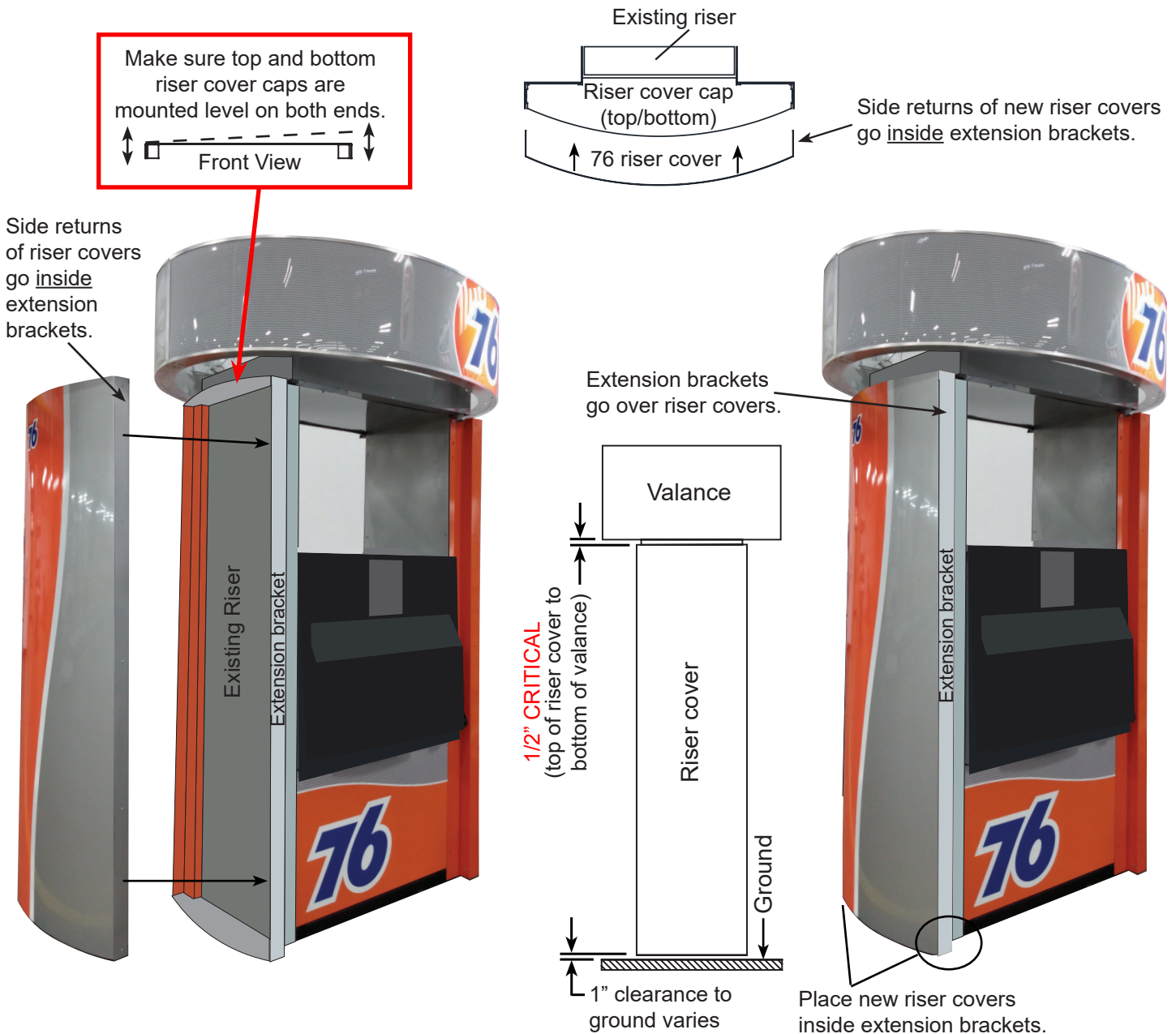

Place riser cover between extension brackets (extension brackets overlap sides of riser cover). Attach by driving K-lathe screws (painted to match extension brackets) thru extension brackets into sides of riser cover. Top and bottom K-lathe screws pass thru side tabs of top and bottom riser cover caps. Install two riser covers per dispenser.

APPENDIX

1/19/2022 - Date created.

3/27/2023 - Removed Shield image parts from guide. Changed gap at top of new riser cover to 1/2" below valance. Shortened guide format and eliminated pages.

4/3/2023 - Changed title on p. 1 to "76 Wave Encore...", and changed term "riser" to "riser cover" throughout document.

